



LV PROPERTY.CO.UK®



Apartment 32 Regal Court 72 Bishopsgate Street

Birmingham, B15 1EJ

Offers Over £155,000



Floor Plan

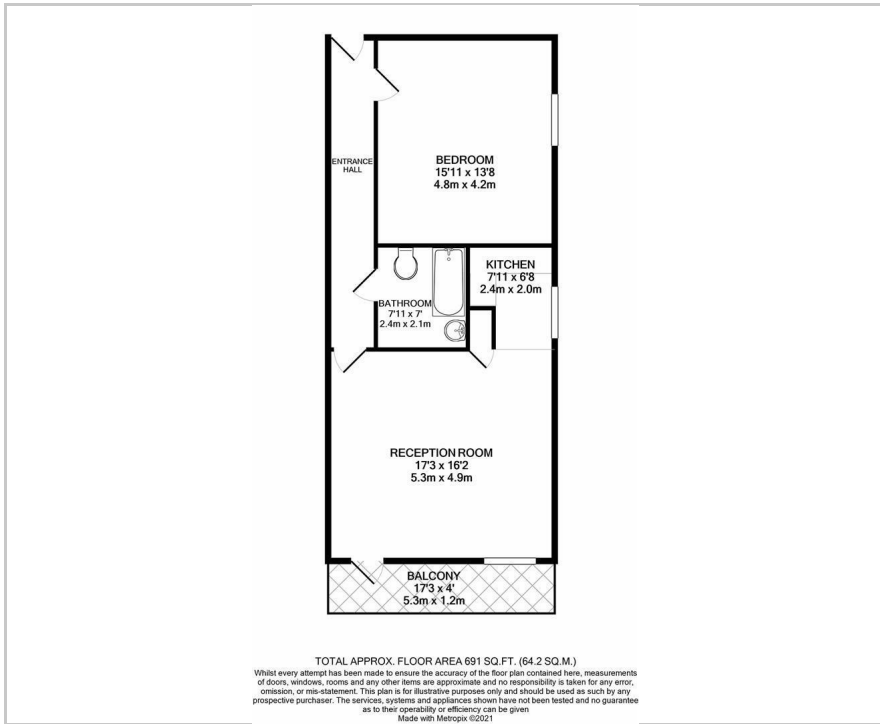

Area Map



Energy Efficiency Graph

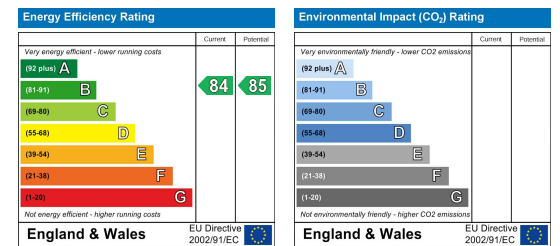

Viewing

Please contact our LV PROPERTY Office on 01212857575 if you wish to arrange a viewing appointment for this property or require further information.

- ONE BEDROOM APARTMENT
- EWS1 NOT REQUIRED FOR THE BLOCK
- GREAT INVESTMENT OR FIRST HOME
- LOOKING TO SELL? GET YOUR FREE PROPERTY VALUATION TODAY
- LARGE BALCONY- GREAT VIEWS
- CITY CENTRE LOCATION
- MINUTES AWAY FROM THE TRAIN STATION AND TRAM LINE
- SIMILAR PROPERTIES REQUIRED

****GREAT VIEWS FROM LARGE BALCONY****

LV PROPERTY is pleased to market this gorgeous property located in central Birmingham offers South Birmingham City views with a high-quality finish. This apartment offers one large double bedroom, with ample light which gives it a very homely atmosphere. The living room/ dining room offers both light and space in abundance, off of the lounge there are doors leading onto the large balcony, which stretches the length of the apartment. SQFT almost 700.

This apartment is located within walking distance to Grand Central, The Mailbox and The Bullring and also has great travel links to the M42, M6, also within minutes of New Street Station and to bus links and airports.

The property is a must-see for both first-time buyers and investors.

Viewings strictly via LV PROPERTY.



These particulars, whilst believed to be accurate are set out as a general outline only for guidance and do not constitute any part of an offer or contract. Intending purchasers should not rely on them as statements of representation of fact, but must satisfy themselves by inspection or otherwise as to their accuracy. No person in this firm's employment has the authority to make or give any representation or warranty in respect of the property.



0121 285 7575
www.lvproperty.co.uk

157c Warstone Lane, Jewellery Quarter,
Birmingham, West Midlands, B18 6NZ